

ICES 2026

10th International Conference on Economic Structures

PAPAIOS



Pan Pacific Association of Input-Output Studies



March 6-7, 2026

at Tokyo International University

(Address: 1-13-1 Matoba-Kita, Kawagoe-shi, Saitama,
350-1197, Japan)

- ◆ Chair of the Organizing Committee:
TSUKUI Makiko (Tokyo International University, Japan)
- ◆ Chair of the Scientific Program Committee:
ISHIRO Taku (Yokohama National University, Japan)
- ◆ Website: <http://www.gakkai.ne.jp/papaios/en/conference.html>
- ◆ Contact: ICES_PAPAIOS@ml.gakkai.ne.jp
- ◆ Organized by the Pan Pacific Association of Input-Output Studies (PAPAIOS)

Access Map



Area Map

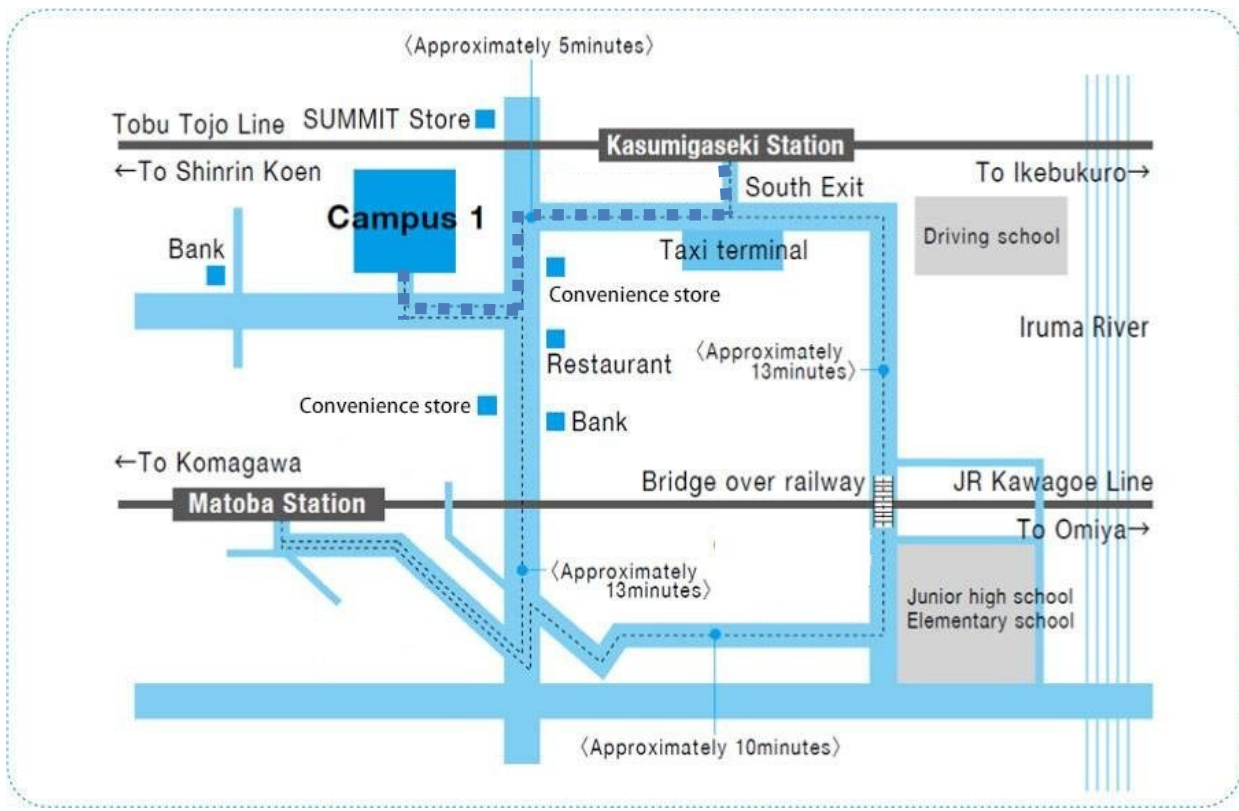

- Tokyo International University, Kawagoe Campus 1**
From Kasumigaseki Station: Approximately 5 minutes on foot. If using the Tobu Tojo Line (express), Kasumigaseki Station is approximately 36 minutes from Ikebukuro Station. If using the Subway Yurakucho Line, it is easiest to change trains at Wakoshi Station to the Tobu Tojo Line (rapid).
- From Matoba Station:** Approximately 13 minutes by foot. If using the JR Kawagoe line (via the Saikyo Line), Matoba Station is approximately 31 minutes from Omiya Station.
- Address: 1-13-1 Matoba-Kita, Kawagoe-shi, Saitama, 350-1197 Tel.049-232- 1111**

Campus Map



Floor Map (Building No.3)

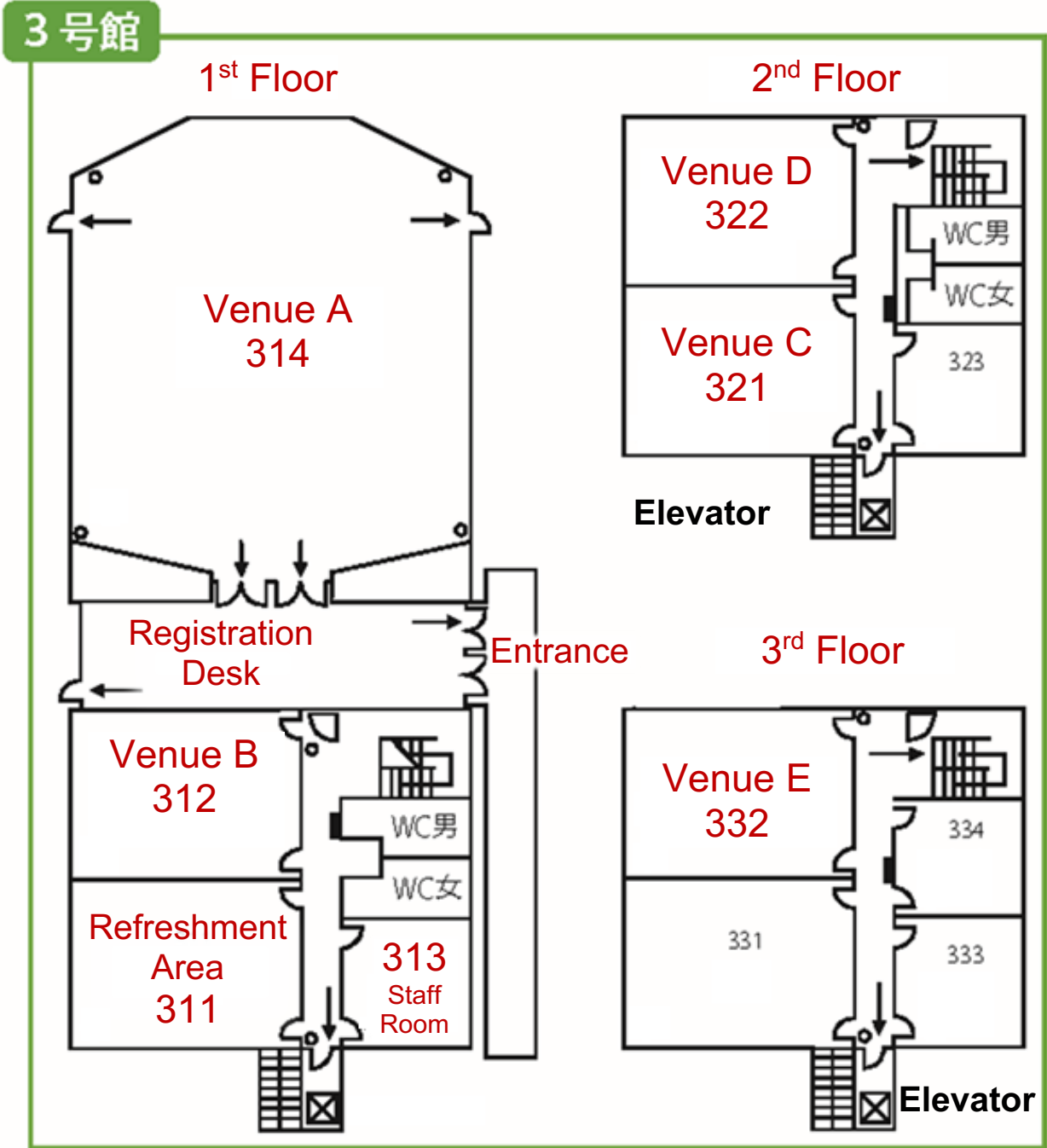

Conference Program Overview

| Conference Program Overview | | | | | | |
|-----------------------------|-------------|---|--|---|---|---|
| | | Venue A (314) | Venue B (312) | Venue C (321) | Venue D (322) | Venue E (332) |
| 6 March | 9:30-9:50 | | Opening Session (Building 3) | | | |
| | 10:00-12:00 | | 4: Regional Input- Output Analysis | 2: Compilation of Input- Output Table or SUT 6: Digital Economy and AI | 8: Environment, Resource and Energy (1) | 5: International Economy and International Development (1) |
| | 12:00-13:30 | Lunch | | | | |
| | 13:30-15:30 | | Organized session: Applications of Input- Output Analysis in Korea: Policy Evaluation and Structural Change | 3: Macroeconomic Modeling and CGE (1) | 8: Environment, Resource and Energy (2) | 5: International Economy and International Development (2) |
| | 15:50-17:20 | | 11: Other Topics(1) | 3: Macroeconomic Modeling and CGE (2) | 9: The Effect of Disaster and Pandemic to Economy | 5: International Economy and International Development (3) |
| | 17:40-17:50 | Greetings to Related Academic Societies | | | | |
| | 17:50-18:40 | Keynote | | | | |
| | 18:50-20:00 | Social gathering (Building 7, Cafe Lounge, 2nd Floor) | | | | |
| 7 March | 10:00-12:00 | | 11: Other Topics(2) | 1: Theory of Input- Output Techniques | 8: Environment, Resource and Energy (3) | |
| | 13:30-15:30 | | 7: Productivity | 10: Finance, Monetary Policy | 8: Environment, Resource and Energy (4) | |

Instructions for Speakers

Presentation Equipment

Speakers may use either their own laptop or the **Windows-based computer provided by the conference** for presentations.

Connection is primarily available via **HDMI**.

USB Type-C connection may also be used using adapters provided by the conference; however, compatibility issues may occur depending on the device.

Speakers are therefore advised to bring a backup copy of their presentation on a USB flash drive (Type-A or Type-C), so that it can be presented using the conference computer if necessary.

A conference laptop will be available in each session room.

This computer has been checked and secured with up-to-date antivirus protection.

Laser Pointers

The conference does not provide laser pointers.

Speakers who wish to use one are requested to bring their own device.

Time Allocation for Presentations

Each presentation slot is 30 minutes (including discussion).

As a general guideline, time signals are given as follows:

- 20 minutes – Bell once (end of presentation)
- 25 minutes – Bell twice (5 minutes remaining)
- 30 minutes – Bell three times (end of session)

Please follow the instructions of the session chair, who has final discretion over time management.

Day 1 Events

Friday 6 March 9:30-9:50

Venue B(312)

- Opening Session**
- Chair: Yoshifumi Ishikawa (Nanzan University)
- Speaker Yoshifumi Ishikawa (Nanzan University)
(President of PAPAIOS)
- Young Researchers' Introductions**
- Chair: Jiyoung Kim (Okayama University)

6 March 10:00-12:00

Venue B (312)

- Regional Input-Output Analysis**
- Chair: Mitsuo Yamada (Chukyo University)
- Title Myanmar's Economic Growth Patterns after 1988 Political Crisis
- Author Ei Ei Thein (Ritsumeikan University)
- Co author Kazuo Inaba (Ritsumeikan University)
- Title Domestic Value Added in Bangladesh's Textile Exports: A Destination-Specific Decomposition, 2007–2023
- Author Mohammad Sayedur Rahman (Yokohama National University)
- Co-author1 Kazuo Inaba (Ritsumeikan University)
- Co-author2 Taku Ishiro (Yokohama National University)
- Title Structural Analysis of Regional Economic Circulation and Interregional Leakage
- Author Naoki Inoda (Yokohama National University)
- Co-author1 Taku Ishiro (Yokohama National University)

6 March 10:00-12:00

Venue C (321)

- Compilation of Input-Output Table or SUT and Digital AI**
- Chair: Mikio Suga (Hosei University)
- Title Robot Adoption and Export Structure in Developing Economies
- Author Karamat Nurillaev (Hokkaido University)
- Title Does Financial Literature Boost the Impact of Mobile Money Adoption on Female-Owned Informal Enterprises?
- Author Usman Alhassan (Ritsumeikan University)
Institute of International Studies
and Public Policy, Royal University
of Phnom Penh, Cambodia
- Co-author1 Kimty Seng (College of Business Administration,
Ritsumeikan University)
- Co-author2 Sachiko Miyata (Ritsumeikan University)

6 March 10:00-12:00

Venue D (322)

- Environment, Resource and Energy(1)**
- Chair: Taku Ishiro (Yokohama National University)
- Title Research on Electricity Footprint of China's Industrial Sectors Based on Input-Output Analysis
- Author Taku Ishiro (Yokohama national university)
- Co-author1 Liu Xie (Wuhan Donghu University)
- Co-author2 Yuxuan Sun (Yokohama national university)
- Co-author3 Jianzhong Xiao (China University of Geosciences)
- Title CO2 Emission Reduction Effect of CCS in China:
- Author Zuoyi Ye (Okinawa International University)
- Co-author1 Takatoshi Watanabe (Aichi Gakuin University)
- Co-author2 Kiyoshi Fujikawa (Aichi Gakuin University)
- Title Toward an Industrial Structure Analysis of a Triple Sustainability Society
- Author Ayu Washizu (Waseda University)
- Co-author1 Sayaka Ita (Tohoku-Gakuin University)

6 March 10:00-12:00

Venue E (332)

- International Economy and International Development(1)**
- Chair: Nobuhiro Okamoto (Daito Bunka University)
- Title ~~Capital and Capital Goods in Trade Theory: A Primer~~
- Author ~~Neha Dhanawade~~ (~~Gokhale Institute of Politics and Economics~~)
- Co-author1 ~~Rajas Parchure~~ (~~Gokhale Institute of Politics and Economics~~)

| | | |
|------------|--|--|
| Title | Measuring Tariff-Shock Effects with an Endogenous Cross-Country Production Network: A Reconstructed Intercountry Input-Output Model | |
| Author | Qi Su | (University of Chinese Academy of Sciences) |
| Co-author1 | Jian Xu | (University of Chinese Academy of Sciences) |
| Title | Labor Value and Exploitation between China and the United States | |
| Author | Ningxin Zhu | (Ritsumeikan University) |
| Co-author1 | Takahiro Hashimoto | (Ritsumeikan University) |

6 March 13:30-15:30
Venue B (312)
Organized session 1: "Applications of Input-Output Analysis in Korea: Policy Evaluation and Structural Change"

| | | |
|---------|---|--|
| Chair: | Jinmyon Lee | (Korea Institute for Industrial Economics and Trade, KIET) |
| Title | Compilation and Analysis of the 2020 Regional IOTs of Korea | |
| Speaker | Seongwoon Lim | (Bank of Korea) |
| Title | Estimation Results and Key Features of the EV Sector in the Korean IO Table | |
| Speaker | Eunjee Noh | (Bank of Korea) |
| Title | Development of a Machine-Learning-Based MRIO Nowcasting Model | |
| Speaker | Junseok Choi | (Korea Institute for Industrial Economics & Trade, KIET) |

6 March 13:30-15:30
Venue C (321)
Macroeconomic Modeling and CGE(1)

| | | |
|------------|---|---|
| Chair: | Shih-Hsun Hsu | (National Taiwan University) |
| Title | An Analysis of the Impacts of Protectionist Trade Policy on the Energy-Economy Structures | |
| Speaker | Shunsuke Mori | (Tokyo University of Science) |
| Title | A Study on the Macroeconomic and Sectoral Impacts of AI Adoption in Taiwan: A Computable General Equilibrium Approach | |
| Speaker | Min-Long Chen | (Institute of Economics, Academia Sinica) |
| Co-author1 | Ching-Cheng Chang | (Institute of Economics, Academia Sinica) |
| Co-author2 | Shih-Hsun Hsu | (National Taiwan University) |
| Title | An Economy-wide Impact Analysis of U.S. Reciprocal Tariffs on Taiwan | |
| Speaker | Ching-Cheng Chang | (Academia Sinica) |
| Co-author1 | Sin Yee Tan | (National Taiwan Ocean University) |
| Co-author2 | Min-Long Chen | (Academia Sinica) |

6 March 13:30-15:30
Venue D (322)
Environment, Resource and Energy(2)

| | | |
|------------|---|--|
| Chair: | Takahiro Hashimoto | (Ritsumeikan University) |
| Title | Research on the Variation Effects of China's Water Resources and Energy Consumption Before and After the Implementation of RCEP (2020 - 2024) Based on the Input - Output Model | |
| Speaker | Yuxuan Sun | (Yokohama National University) |
| Co-author1 | Taku Ishiro | (Yokohama National University) |
| Title | The Impact of Converting Fossil Fuel Taxes to Pure Carbon Tax on Household Expenditure in Japan | |
| Speaker | Koki Yada | (Graduate school, Nagoya University) |
| Title | THE ILLUSION OF DECARBONIZATION: PRODUCTION-CONSUMPTION ASYMMETRIES IN THE GLOBAL AUTOMOTIVE TRADE (2017-2023) | |
| Speaker | Shreedhar Gautam | (Yokohama National University) |

6 March 13:30-15:30
Venue E (332)
International Economy and International Development(2)

| | | |
|---------|--|---|
| Chair: | Zuoyi Ye | (Okinawa Interantional University) |
| Title | Measuring the High-Quality Development of China-ASEAN Emerging High-Tech Product Trade | |
| Speaker | Suppakorn Khonkhlong | (School of Economic and Management, Wuhan University) |

| | | |
|----------------------------|---|--|
| Co-author1 | Yongming Huang | China Institute of Development (Strategy and Planning, Wuhan University) |
| Title | Panel Data Analyses on the Relationships between Changes in GDP and GVCs using OECD ICIO2025 and ADB MRIO2025 | |
| Author | Masaaki Kuboniwa | (Hitotsubashi University) |
| Co-author1 | Yusuke Nakatani | (Bunri University) |
| Title | ASSESSING THE REGIONAL IMPACTS OF TOURISM EXPANSION IN CANADA: AN INTERPROVINCIAL INPUT-OUTPUT APPROACH | |
| Speaker | Kakali Mukhopadhyay | (McGill University) |
| Co-author1 | Vishnu S. Prabhu | (McGill University) |
| 6 March 15:40-17:20 | | Venue B (312) |
| | Other Topics(1) | |
| Chair: | Masaru Ichihashi | (Hiroshima University) |
| Title | Can Creative Industries Drive Regional Growth? | |
| Author | Takeshi Nagamune | (Niimi university) |
| Title | Remittances, Credit Access and Household Resilience to Shocks: Evidence from Rural Vietnam | |
| Author | Hue Vu Thi My | (Hiroshima University) |
| Title | Tax Evasion and Economic Growth: Evidence from South Asian Economies | |
| Author | Asma Humayun | (Ritsumeikan University BKC Campus) |
| Co-author1 | Xuemei Shen | (Ritsumeikan University) |
| Co-author2 | Waheed Abdul | (Kyoto University) |
| 6 March 15:40-17:20 | | Venue C (321) |
| | Macroeconomic Modeling and CGE(2) | |
| Chair: | Shunsuke Mori | (Tokyo University of Science) |
| Title | Can Megaregions Balance Regional Development? A Spatial CGE Assessment of South Korea | |
| Author | Euijune Kim | (Seoul National University) |
| Co-author1 | Seulki Kim | (Seoul National University) |
| Title | How Digital Technologies Mediate the Trade-Growth Nexus through Skill Upgrading in Central America and the Caribbean | |
| Author | Roxanna Shawn Pena | (Ritsumeikan University) |
| Co-author1 | Inaba Kazuo | (Ritsumeikan University) |
| 6 March 15:40-17:20 | | Venue D (322) |
| | The Effect of Disaster and Pandemic to Economy | |
| Chair: | Tsutomu Yoshioka | (Aichi Gakuin University) |
| Title | Comparing Lockdown and Non-Lockdown Economies during COVID-19: Evidence from Multi-Regional Input-Output Analysis | |
| Author | Bui Xuan Hong | (SmaSo, Hiroshima University) |
| Co-author1 | Masaru Ichihashi | (Hiroshima University) |
| Title | Natural disasters, covid 19 and the internationalization of Vietnam's labor force: A resilience framework approach | |
| Author | Dung Thi Thuy Mai | (Ritsumeikan University) |
| Title | Integrating Input-Output Structural Decomposition with Firm-Level Transaction Networks | |
| Author | Kiyotaka Ishikawa | (Surugadai University) |
| 6 March 15:40-17:20 | | Venue E (332) |
| | International Economy and International Development(3) | |
| Chair: | Shrestha Nagendra | (Yokohama National University) |
| Title | Measuring Indirect Value-Added via Third Countries: A Path Decomposition Analysis under the US-China Trade War | |
| Author | Yuxiang Huang | (Ritsumeikan University) |
| Title | Cash or Machinery? A Theory of Migrant-Driven Technology Diffusion | |
| Author | Mishael Joy Barrera | (BKC Research Organization of Social Sciences, Ritsumeikan University) |
| Co-author1 | Jean-Claude Maswana | (Ritsumeikan University) |

| Greetings to Related Academic Societies 17:40-17:50 | | Venue A(314) |
|--|---|--|
| Speaker | Jinmyon Lee President, The Korean Association of Economic Systems Research Analysis (KESRA) | (Korea Institute for Industrial Economics and Trade, KIET) |
| Speaker | Ching-Cheng Chang (President, Taiwan Association of Input-Output Studies (TAIOS)) | (Academia Sinica) |
| Keynotespeaker 17:50-18:40 | | Venue A(314) |
| Chair | Taku Ishiro | (Yokohama National University) |
| Speaker | Jinmyon Lee Senior Research Fellow, Institute for Industrial Economics & Trade (KIET) President, The Korean Association of Economic Systems Research Analysis (KESRA) | |
| Title | Compilation and Applications of Input-Output Tables in Korea | |

Day 2 Events

| 7 March 10:00-12:00 | | Venue B (312) |
|--|---|--|
| Other Topics(2) | | |
| Chair: | Kazuo Inaba | (Ritsumeikan University) |
| Title | Estimating Interregional Trade Flows with Limited Data: An Optimization Approach | |
| Author | Thi Bich Thao Dang | (University of Tokyo) |
| Co-author1 | Morito Tsutsumi | (University of Tsukuba) |
| Co-author2 | Lam Anh Duong Tran | (University of Tsukuba) |
| Title | A Simulation Analysis of International Food Supply Risks and Their Impacts on Japan's Food System | |
| Author | Katsuhiko Saito | (Sophia University) |
| Title | Changes of Sectoral Linkages and Income Multipliers in Bangladesh: Evidence from Social Accounting Matrices, 2017-2022 | |
| Author | Jahan Mashrat | (Sophia University) |
| Co-author1 | Cardenete Flores Manuel Alejandro | (Universidad Loyola Andalucia, Spain) |
| Co-author2 | Tetsuya Horie | (Department of Economics, Sophia University) |
| Co-author3 | Beltran Jaimes Luz Dary | (Department of Economics, Universidad Loyola Andalucia, Spain) |
| 7 March 10:00-12:00 | | Venue C (321) |
| Theory of Input-Output Techniques | | |
| Chair: | Satoru Hagino | (Reitaku University) |
| Title | Exploring the Feasible Solutions of Generalized Product-Balance Equation within Various Identifying Assumptions | |
| Author | Vladimir Motorin | (Higher School of Economics) |
| Title | Multiplier Decomposition of Multi-Regional Effects | |
| Author | Jun Omata | (Graduate School of Meiji University) |
| Title | An interregional input-output analysis with agglomeration economies: Isard meets Krugman | |
| Author | Ryo Itoh | (Tohoku University) |
| 7 March 10:00-12:00 | | Venue D (322) |
| Environment, Resource and Energy(3) | | |
| Chair: | Xuemei Shen | (Ritsumeikan University) |
| Title | Input-output analysis on the life-cycle CO2 circulation of direct air capture and methanation by using the OECD-ICIO database | |
| Author | Mitsuo Yamada | (Chukyo University) |
| Co-author1 | Keiko Nakayama | (Chukyo University) |
| Co-author2 | Soichiro Masuda | (Toho Gas Co., Ltd.) |
| Co-author3 | Koyo Norinaga | (Graduate School of Engineering, Nagoya University) |
| Title | Assessing Water Footprints in Drought-Vulnerable Small Islands Region: Case of East Nusa Tenggara, Indonesia | |
| Author | Muhammad Fikruzzaman Rahawarin | (Center for National Development and Knowledge) |

| | | |
|------------|--|--------------------------|
| Title | Asia-Pacific's Transition: Emissions, Social Cost of Carbon, and GVC Positions in Heavy Industry | (Hiroshima University) |
| Author | Shuning Chen | (Kyoto University) |
| Co-author1 | Masaru Kagatsume | (Kyoto University) |

7 March 13:30-15:30
Venue B (312)

| | | |
|---------------------|---|---|
| Productivity | | |
| Chair: | Jiyoung Kim | (Okayama University) |
| Title | Is Brand Marketing Assets or Human Capital? | |
| Author | Satoru Hagino | (Reitaku University) |
| Title | Multinational Enterprises and Productivity Spillovers: Evidence from Selected Services in India | |
| Author | Pooja Dinesh Thakur | (Gokhale Institute of Politics and Economics) |
| Co-author1 | Shivani Bankar | (Gokhale Institute of Politics and Economics) |
| Title | The Impact of Social Security Expenditure on Economic Growth in China: The Role of Human Capital Investment | |
| Author | Chung Khain Wye | (Universiti Kebangsaan Malaysia) |
| Co-author1 | Yonglan Yan | (Guangzhou College of Technology and Business, China Faculty of Economics and Management, Universiti Kebangsaan Malaysia) |
| Co-author2 | Hazrul Shahiri | (Management, Universiti Kebangsaan Malaysia) |

7 March 13:30-15:30
Venue C (321)

| | | |
|---------------------------------|---|--|
| Finance, Monetary Policy | | |
| Chair: | Kiyoshi Yonemoto | (Takasaki City University of Economics) |
| Title | Employee Engagement as the Mediator of Digital Transformation Adoption: An Extended UTAUT Model in the Laotian Banking Sector | |
| Author | Soulita Tiengmany | (Yamaguchi University) |
| Co-author1 | Huu Phuc Nguyen | (Yamaguchi University) |
| Title | Policy Responses and Market Liquidity in Six Major Economies during Crises | |
| Author | Junhuan Zhang | (Graduate School of Economics, Ritsumeikan University) |

7 March 13:30-15:30
Venue D (322)

| | | |
|--|---|---------------------------------------|
| Environment, Resource and Energy(4) | | |
| Chair: | Ayu Washizu | (Waseda University) |
| Title | Does Education Stipend Program Steer Energy Ladder Pattern? The Case of Bangladesh | |
| Author | Md Ubaydullah | (Ritsumeikan University) |
| Title | THE RELATIONSHIP BETWEEN CORPORATE ENVIRONMENTAL ACTIVITIES AND FINANCIAL PERFORMANCE | |
| Author | Pham Thu Thao | (Ritsumeikan University) |
| Co-author1 | Izumi Inasawa | (Ritsumeikan University BKC Campus) |
| Co-author2 | Xuemei Shen | (Ritsumeikan University) |
| Title | China's Manufacturing Transfer to Vietnam: A Sectoral Input–Output Assessment (1995–2022) | |
| Author | Thi Ngoc Anh Phung | (Wuhan University) |
| Co-author1 | Yongming Huang | (Wuhan University) |

Friday, March 6

The Keynote Speaker



Jinmyon Lee

Senior Research Fellow,
Korea Institute for Industrial Economics & Trade
(KIET)

Dr. Jinmyon Lee is a Senior Research Fellow at the KIET and a leading expert in industrial economics and input–output analysis. With more than three decades of experience in policy-oriented research and academia, he has conducted extensive empirical studies on industrial structure and economy-wide spillover effects.

His research focuses on the use of input–output tables and multi-regional input–output (MRIO) models to analyze structural change, economic growth, and inter-industry linkages in trade and services. He has made significant contributions to the quantitative evaluation of industrial and macroeconomic policies through analysis of inter-industry and inter-regional linkages.

Dr. Lee has held senior research positions at major Korean policy research institutions, including the Korea Development Institute (KDI) and KIET, and has served as a visiting researcher and visiting professor in Japan and China. He has also played leading roles in academic communities and currently serves as an advisory member of the Input–Output Team at the Bank of Korea, as well as an editorial board member of the *Journal of Economic Structures*.

In his keynote address, Dr. Lee will discuss the evolution, compilation systems, and applications of various types of input–output tables in Korea, and present perspectives on future development directions of Korea’s input–output framework.



**International Conference on Economic Structures 2026 Tokyo
International University, Japan, March 6-7, 2026**

Organizing Committee

Chair: TSUKUI Makiko, Tokyo International University, Japan
MATSUMURA Atsuko, Tokyo International University, Japan
KANO Sakugi, Okinawa International University, Japan
ISHIRO Taku, Yokohama National University, Japan
ISHIKAWA Yoshifumi, Nanzan University, Japan

Scientific Program Committee

Chair: ISHIRO Taku, Yokohama National University, Japan
ITAKURA Ken, Nagoya City University, Japan
ICHIHASHI Masaru, Hiroshima University, Japan
OKAMOTO Nobuhiro, Daito Bunka University, Japan
KIM Jiyoun, Okayama University, Japan

Organized by the Pan Pacific Association of Input-Output Studies (PAPAIOS)

Contact: ICES_PAPAIOS@ml.gakkai.ne.jp

Web site: <https://www.gakkai.ne.jp/papaios/en/conference.html>